

YOSHI

plush



a free embroidery design by



YOSHI PLUSH EMBROIDERY DESIGN

OVERVIEW

These embroidery files contain the eye and nostril designs for the **YOSHI PLUSH SEWING PATTERN**.



EYES

Stitches out eye whites and pupils for the **EYES (A)**.

FITS: hoops 4" x 4" and above



NOSTRILS

Stitches out nostrils for the **NOSE (M)**.

FITS: hoops 4" x 4" and above

MATERIALS & TOOLS:

- 7" x 6" piece of green fabric for **EYE (A)**
- 4" x 4" piece of white fabric for eye white applique
- 13" x 13" piece of green fabric for **NOSE (M)**
- medium to heavy-weight cut-away stabilizer
- water soluble top stabilizer (if using minky)
- white thread for eye applique and eye shines
- black thread for pupils and nostrils
- basic embroidery tools: (embroidery machine, embroidery scissors, spray adhesive, bobbin thread, sewing needles, embroidery hoops, masking tape)

sew desu ne?

| WWW.CHOLYKNIGHT.COM |

// ©2024 Choly Knight // Items sewn using this design may be sold. Credit to "Choly Knight" or "Sew Desu Ne?" is appreciated.
You may not reproduce, share, freely distribute, or sell this design as your own in digital or printed form.

YOSHI EYES:

SIZE: 95mm x 74mm (3.7 in x 2.9 in)

COLORS:

Colors needed: 2

- eye whites, eye shines
- pupils

Color changes: 6

FABRIC:

- 7" x 6" piece of green fabric for **EYE (A)**
- 4" x 4" piece of white fabric for eye white applique

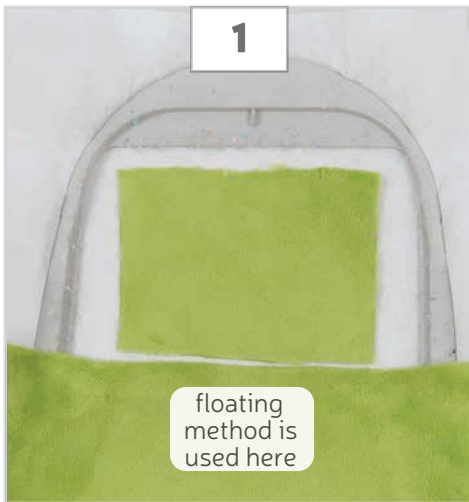
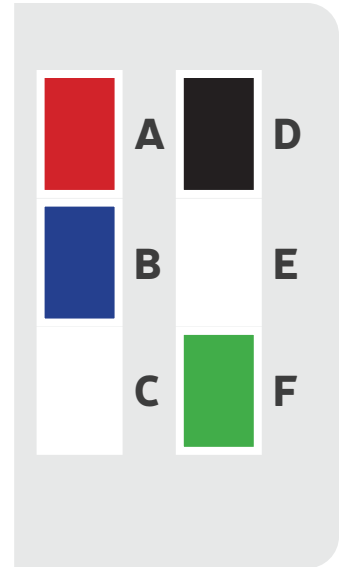
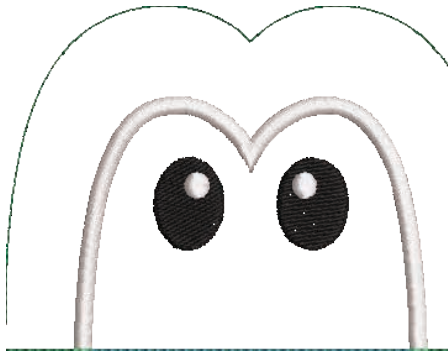

HOOP YOUR FABRIC

- The sample is hooped with the floating method, so the fabric is adhered to the top of cut-away stabilizer. Water-soluble stabilizer is taped on top later.



APPLIQUE PLACEMENT

- This creates a guideline for placing your **EYE WHITE** fabric.

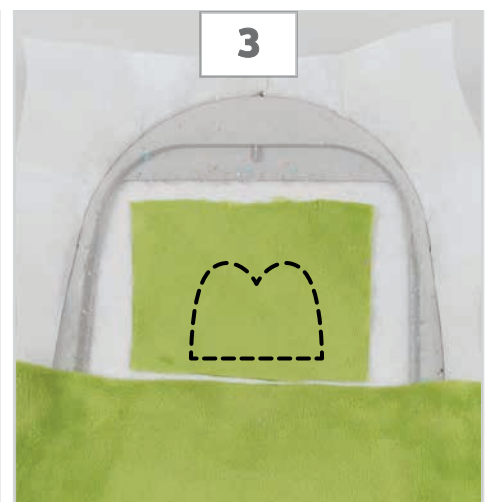

REMOVE THE HOOP

- Remove the hoop from your machine. Trim the threads.

sew desu ne?

| WWW.CHOLYKNIGHT.COM |

// ©2024 Choly Knight // Items sewn using this design may be sold. Credit to "Choly Knight" or "Sew Desu Ne?" is appreciated. You may not reproduce, share, freely distribute, or sell this design as your own in digital or printed form.



4a

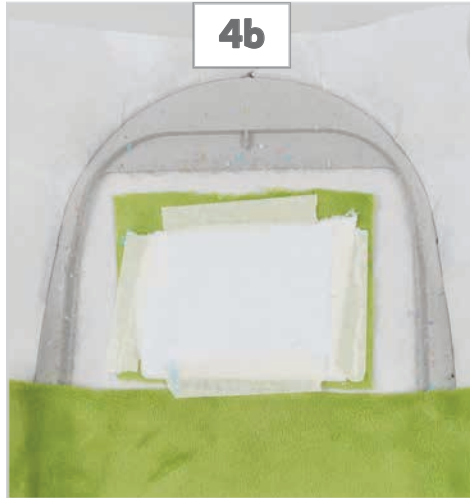

4b



5

COLOR B

PLACE THE APPLIQUE FABRIC

- Place the **EYE WHITE** fabric over the stitched guideline.
- Tape the edges of the fabric in place to hold for the next stitching.
Place the hoop back in the machine.

APPLIQUE OUTLINE

- Use a thread color that matches your applique fabric for this step.
- This secures the edge of the **EYE WHITE** fabric.



6a

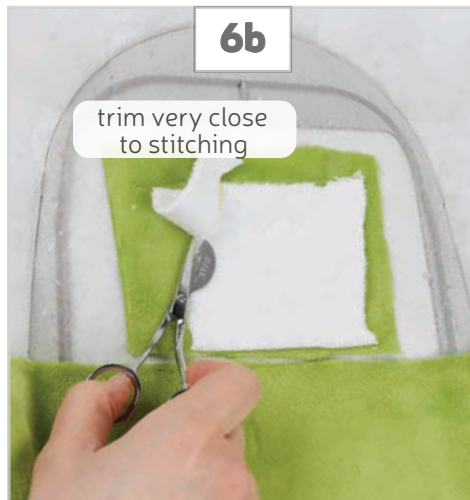

6b

trim very close
to stitching

6c

clean up with
lint roller

TRIM THE APPLIQUE FABRIC

- Remove the hoop from the machine. Trim the threads.
- Trim the **EYE WHITE** fabric as close as you can around the stitching. Use curved embroidery scissors for the best result.
- Run a lint roller over the cut edges if using a fur fabric like minky. This will eliminate any stray fuzz.

sew desu ne?

| WWW.CHOLYKNIGHT.COM |

/// ©2024 Choly Knight /// Items sewn using this design may be sold. Credit to "Choly Knight" or "Sew Desu Ne?" is appreciated.
You may not reproduce, share, freely distribute, or sell this design as your own in digital or printed form.



ADD THE TOP STABILIZER

- a. Tape water-soluble stabilizer over the whole applique area.

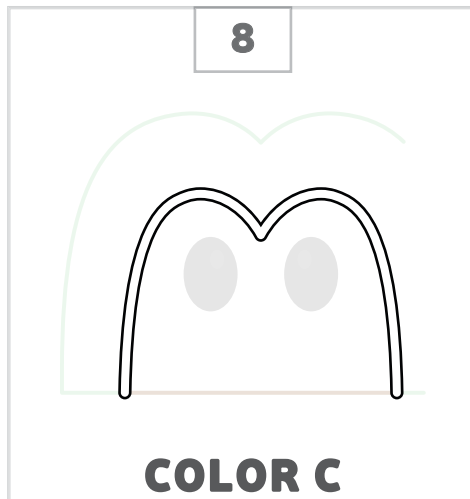

APPLIQUE EDGE

- Use a thread color that matches your applique fabric for the best result.
- This creates satin stitching that will cover the cut edge of your **EYE WHITE** fabric.



PUPILS

- Black would work best here.



EYE SHINES

- White would work best here.

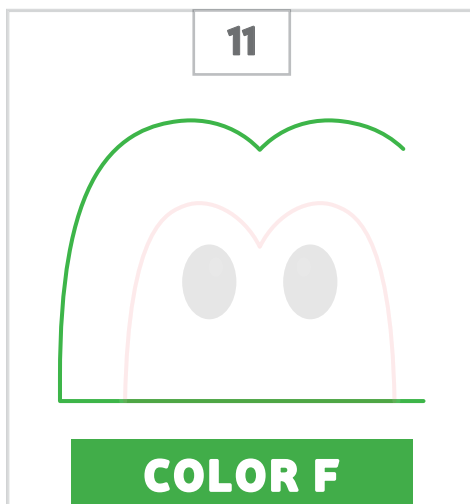

ALIGNMENT GUIDE

- Any color can be used for this.
- This stitches out a guideline for cutting the pattern piece.



CUT THE PATTERN

- a. Remove the hoop and trim the threads. Remove the stabilizers.
- b. Align the **EYE (A)** pattern onto the embroidery, matching up the paper with the alignment stitching.
- c. Cut around the pattern.

sew desu ne?

| WWW.CHOLYKNIGHT.COM |

YOSHI NOSTRILS:

SIZE: 95mm x 93mm (3.7 in x 3.7 in)

COLORS:

Colors needed: 1

- nostrils

Color changes: 2

FABRIC:

- 13" x 13" piece of green fabric for **NOSE (M)**

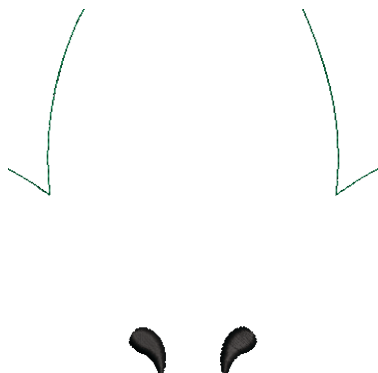

HOOP YOUR FABRIC

- Hoop your **NOSE (M)** fabric and cut-away stabilizer into an embroidery hoop 4" x 4" or larger.
- Hoop water-soluble stabilizer with the fabric, or tape it on afterwards.



NOSTRILS

- Black or a color several shades darker than your main fabric would work well here.



ALIGNMENT GUIDE

- Any color can be used for this.
- This stitches out a guideline for cutting the pattern piece.

sew desu ne?

| WWW.CHOLYKNIGHT.COM |

// ©2024 Choly Knight // Items sewn using this design may be sold. Credit to "Choly Knight" or "Sew Desu Ne?" is appreciated. You may not reproduce, share, freely distribute, or sell this design as your own in digital or printed form.



CUT THE PATTERN

- a.** When finished embroidering, remove the hoop from the machine and trim the threads. Rip off the water-soluble stabilizer and cut away the backing stabilizer.
- b.** Align the **NOSE (M)** pattern onto the embroidery, matching up the paper with the alignment stitching.
- c.** Pin the paper pattern in place (or trace the outline). Cut around the pattern.
Use the fabric as usual with the rest of the project instructions.

sew desu ne?

| WWW.CHOLYKNIGHT.COM |

// ©2024 Choly Knight // Items sewn using this design may be sold. Credit to "Choly Knight" or "Sew Desu Ne?" is appreciated.
You may not reproduce, share, freely distribute, or sell this design as your own in digital or printed form.